

PRODUCT SPECIFICATIONS

Construction:

- Frosted Acrylic Lens
- White, Brushed Nickel, Or Bronze Finish Options
- Aluminum Construction

Light Source:

- 14.8 Watts LED 1050 Lumens
- Triac Dimmable Or 0-10V Dimming Option
- 120V 3000°K 90 CRI

Notes:

- Wet Location Listed
- Mounts To Any 4" Junction Box
- No Recessed Can Required
- Eliminates The Need For Prelim Drywall
- ETL Approved
- 50,000/Hr Life Expectancy
- DOB Technology Totally Flush With Ceiling
- California T24 JA8

JOB NAME:	
TYPE:	



Diameter: 7 1/2"
Height: 1"

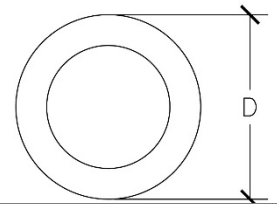
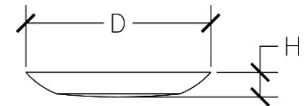

Ordering Information

Example: SL-LED2074-D0-WH-J

SL-LED2074	14.8	7 1/2			J
-------------------	-------------	--------------	--	--	----------

SERIES	WATTAGE	DIAMETER	DIMMING	FINISH	TITLE 24
--------	---------	----------	---------	--------	----------

SL-LED2074	14.8W LED-1050 Lumens	7 1/2	D0- 0-10V Dimmable	WH-White BN-Brushed Nickel BZ-Bronze	J-JA8
------------	-----------------------	-------	--------------------	--	-------



425 North Fox Street San Fernando, CA 91340
(818) 365-8900 FAX (818) 365-2519
www.southlandlighting.net

SOUTHLAND
L I G H T I N G